

ROLLER CHAINS WITH EXTENDED AND HOLLOW PINS

ČZ Standard

Simplex roller and bush chains with one side extended pin	63–65
Simplex roller chains with both side extended pins	66–67
Duplex roller chains with one side extended pins	68
Triplex roller chains with one side extended pins	69
Simplex roller chains with extended shouldered pins	70–71
Duplex roller chains with extended shouldered pins	72
Special extended pins	73
Simplex roller chains with hollow pins	74–75
Duplex roller chains with hollow pins	76–77
Simplex roller chains with extended bars	78
Roller chains with rotary bushes	79
Conveyor chain belts	80

Hollow pin chains build another group of conveyor chains.

These chains are of standard design only the solid pin is replaced with hollow pins (the same shape like bushes).

This solution acts as an easy and simple application of attachments in the shape of bars, screws, etc.

The picture shows the design and possible application.

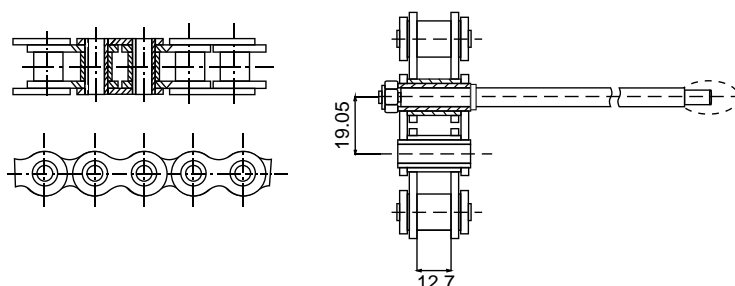

Conveyor chains with hollow pins and examples of application

Simple chains with extended pins mainly use pins from duplex or triplex chains but the pin length, combination and positioning in the chain is discretionary.

We also produce pin modifications that have various attachment diameters, shoulders, holders, threads, etc.

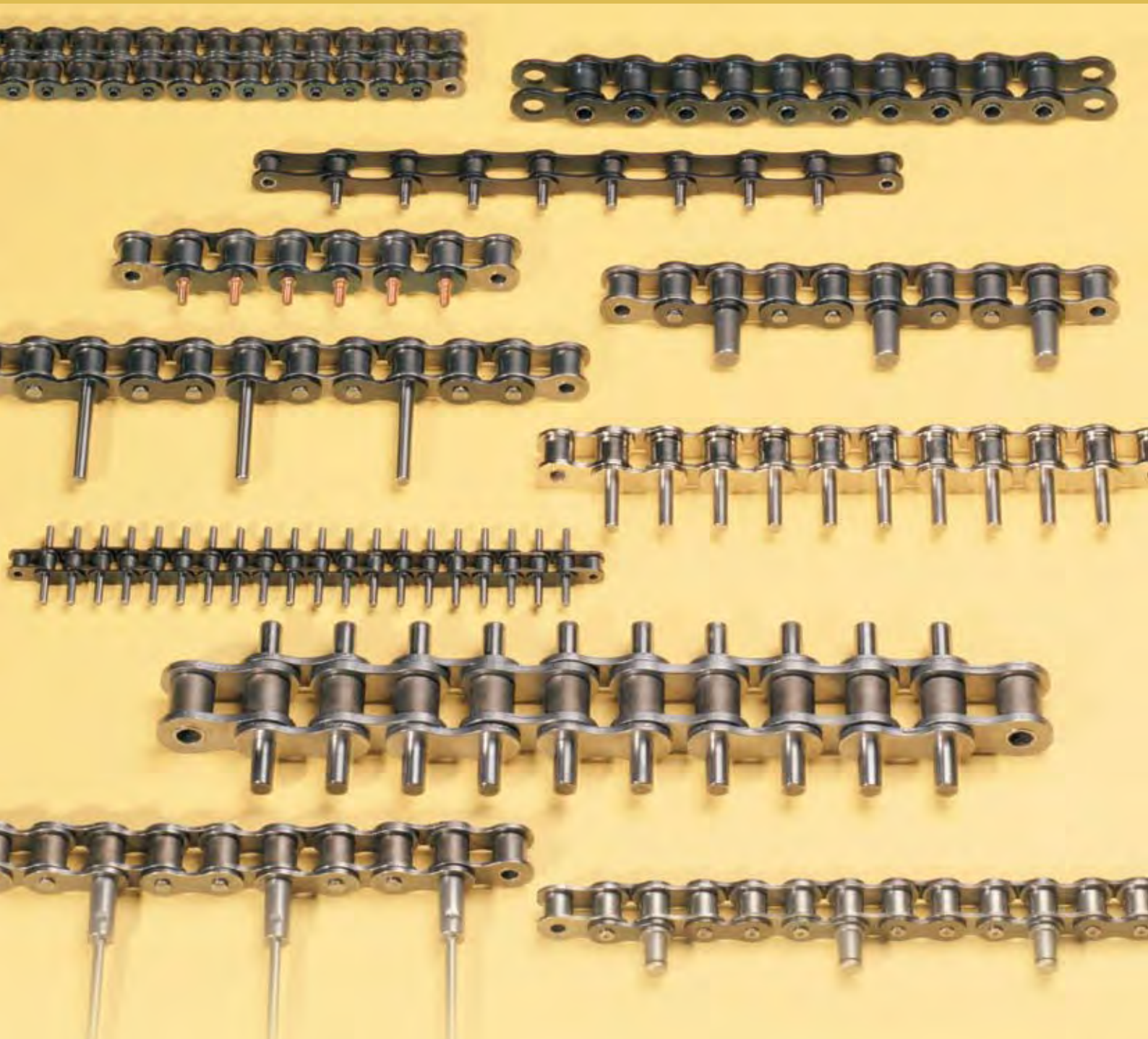

EXTENDED AND HOLLOW PIN CHAINS

- are used for direct transport of goods or can be also used in combination with various accessories

Applications: conveyors for farming, chemical, electrotechnical, printing, dairy, bake and packaging industry

SIMPLEX ROLLER AND BUSH CHAINS WITH ONE SIDE EXTENDED PIN

ČZ Standard

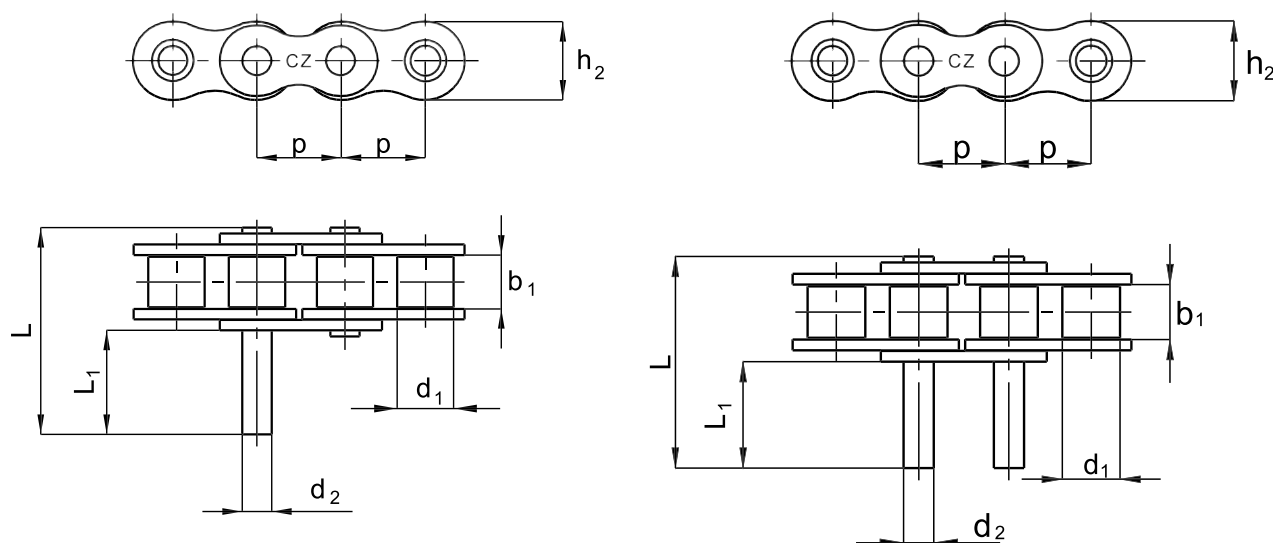

TRADE MARK ČZ	PITCH	INSIDE WIDTH	ROLLER DIAMETER (BUSH)	PIN DIAMETER	PIN LENGTH	PIN EXTENSION	INNER PLATE WIDTH
	p	b1 min.	d1 max.	d2 max.	L max.	L1 max.	h2 max.
	mm	mm	mm	mm	mm	mm	mm
05 B-1	8,0	3,00	5,00	2,31	10,25	3,00	7,20
05 B-1	8,0	3,00	5,00	2,31	12,25	5,00	7,20
05 B-1	8,0	3,00	5,00	2,31	24,00	16,80	7,20
06 B-1*	9,525	5,72	6,35	3,28	14,80	3,00	8,20
06 B-1*	9,525	5,72	6,35	3,28	16,80	5,00	8,20
06 B-1*	9,525	5,72	6,35	3,28	21,75	10,00	8,20
06 B-1*	9,525	5,72	6,35	3,28	22,65	10,90	8,20
06 B-1*	9,525	5,72	6,35	3,28	23,70	12,00	8,20
06 B-1*	9,525	5,72	6,35	3,28	32,90	21,25	8,20
06 C-1*	9,525	4,77	5,08 BUSH	3,58	32,60	21,50	8,20
081	12,7	3,30	7,75	3,66	13,60	4,85	9,90
081	12,7	3,30	7,75	3,66	20,00	11,20	9,90
081	12,7	3,30	7,75	3,66	25,50	16,50	10,00
081	12,7	3,30	7,75	3,66	31,00	22,00	10,00
1/2"x3/16" VELO	12,7	4,88	7,75	3,66	16,50	6,00	9,90
1/2"x3/16" VELO	12,7	4,88	7,75	3,66	20,50	10,00	9,90

*Only with straight plates



SIMPLEX ROLLER AND BUSH CHAINS WITH ONE SIDE EXTENDED PIN

ČZ Standard

TRADE MARK ČZ	PITCH	INSIDE WIDTH	ROLLER DIAMETER (BUSH)	PIN DIAMETER	PIN LENGTH	PIN EXTENSION	INNER PLATE WIDTH
	p	b1 min.	d1 max.	d2 max.	L max.	L1 max.	h2 max.
	mm	mm	mm	mm	mm	mm	mm
1/2"x3/16" VELO	12,7	4,88	7,75	3,66	35,50	25,00	9,90
062 C-1	9,525	9,52	6,00 BUSH	4,18	31,40	15,25	9,25
086	12,7	5,21	8,51	4,45	30,45	17,50	11,80
08 B-1	12,7	7,75	8,51	4,45	18,55	3,00	11,80
08 B-1	12,7	7,75	8,51	4,45	20,60	5,00	11,80
08 B-1	12,7	7,75	8,51	4,45	21,60	6,00	11,80
08 B-1	12,7	7,75	8,51	4,45	23,30	7,80	11,80
08 B-1	12,7	7,75	8,51	4,45	23,75	8,20	11,80
08 B-1	12,7	7,75	8,51	4,45	24,00	8,50	11,80
08 B-1	12,7	7,75	8,51	4,45	25,00	9,50	11,80
08 B-1	12,7	7,75	8,51	4,45	27,00	11,50	11,80
08 B-1	12,7	7,75	8,51	4,45	28,80	13,20	11,80
08 B-1	12,7	7,75	8,51	4,45	30,45	14,90	11,80
08 B-1	12,7	7,75	8,51	4,45	32,30	16,80	11,80
08 B-1	12,7	7,75	8,51	4,45	33,05	17,50	11,80
08 B-1	12,7	7,75	8,51	4,45	34,00	18,40	11,80
08 B-1	12,7	7,75	8,51	4,45	35,55	20,00	11,80
08 B-1	12,7	7,75	8,51	4,45	40,55	25,00	11,80
08 B-1	12,7	7,75	8,51	4,45	44,25	28,70	11,80
08 B-1	12,7	7,75	8,51	4,45	46,50	31,00	11,80
08 B-1	12,7	7,75	8,51	4,45	57,50	42,00	11,80
10 A-1	15,875	9,53	10,16	5,08	26,20	7,40	14,50
10 A-1	15,875	9,53	10,16	5,08	28,00	9,00	14,50
10 B-1	15,875	9,65	10,16	5,08	20,20	2,50	14,50
10 B-1	15,875	9,65	10,16	5,08	25,70	8,00	14,50
10 B-1	15,875	9,65	10,16	5,08	26,10	8,40	14,50
10 B-1	15,875	9,65	10,16	5,08	29,80	12,00	14,50
10 B-1	15,875	9,65	10,16	5,08	30,00	12,25	14,50
10 B-1	15,875	9,65	10,16	5,08	31,00	13,30	14,50
10 B-1	15,875	9,65	10,16	5,08	35,30	17,60	14,50
10 B-1	15,875	9,65	10,16	5,08	37,80	20,00	14,50
10 B-1	15,875	9,65	10,16	5,08	40,00	22,30	14,50

SIMPLEX ROLLER AND BUSH CHAINS WITH ONE SIDE EXTENDED PIN

ČZ Standard

TRADE MARK ČZ	PITCH	INSIDE WIDTH	ROLLER DIAMETER (BUSH)	PIN DIAMETER	PIN LENGTH	PIN EXTENSION	INNER PLATE WIDTH
	p	b1 min.	d1 max.	d2 max.	L max.	L1 max.	h2 max.
	mm	mm	mm	mm	mm	mm	mm
10 B-1	15,875	9,65	10,16	5,08	42,70	32,00	14,50
10 B-1	15,875	9,65	10,16	5,08	51,90	34,15	14,50
10 B-1	15,875	9,65	10,16	5,08	68,60	50,80	14,50
10 B-1	15,875	9,65	10,16	5,08	85,20	67,40	14,50
12 B-1	19,05	11,68	12,07	5,72	24,60	3,70	16,10
12 B-1	19,05	11,68	12,07	5,72	31,00	10,00	16,10
12 B-1	19,05	11,68	12,07	5,72	41,75	20,80	16,10
12 B-1	19,05	11,68	12,07	5,72	42,15	21,15	16,10
12 B-1	19,05	11,68	12,07	5,72	61,25	40,40	16,10
12 A-1	19,05	12,70	11,91	5,94	38,60	14,50	17,70
12 A-1	19,05	12,70	11,91	5,94	48,20	24,10	17,70
12 A-1	19,05	12,70	11,91	5,94	54,15	30,00	17,70
12 A-1 H	19,05	12,70	11,90	5,94	48,20	20,60	17,70
12 B-1 STRONG	19,05	11,68	12,07	6,10	63,60	40,40	17,70
16 B-1	25,4	17,02	15,88	8,28	53,50	20,00	21,00
16 B-1	25,4	17,02	15,88	8,28	58,65	25,00	21,00
16 B-1	25,4	17,02	15,88	8,28	63,70	30,00	21,00
16 B-1	25,4	17,02	15,88	8,28	65,20	31,50	21,00
16 B-1	25,4	17,02	15,88	8,28	67,30	33,60	21,00
16 B-1	25,4	17,02	15,88	8,28	73,65	40,00	21,00
16 B-1	25,4	17,02	15,88	8,28	90,70	57,00	21,00
16 B-1	25,4	17,02	15,88	8,28	99,10	65,40	21,00
208 B	25,4	7,75	8,51	4,45	25,50	10,00	12,00
208 B	25,4	7,75	8,51	4,45	30,45	14,90	12,00
208 B	25,4	7,75	8,51	4,45	44,25	28,70	12,00
210 B	31,75	9,65	10,16	5,08	35,30	17,60	14,40
210 B	31,75	9,65	10,16	5,08	51,90	34,15	14,40
212 B	38,1	11,68	12,07	5,72	28,00	7,00	16,40
212 B	38,1	11,68	12,07	5,72	41,75	20,80	16,40
212 B	38,1	11,68	12,07	5,72	61,25	40,40	16,40
212 A	38,1	12,70	11,91	5,94	35,10	11,00	16,40

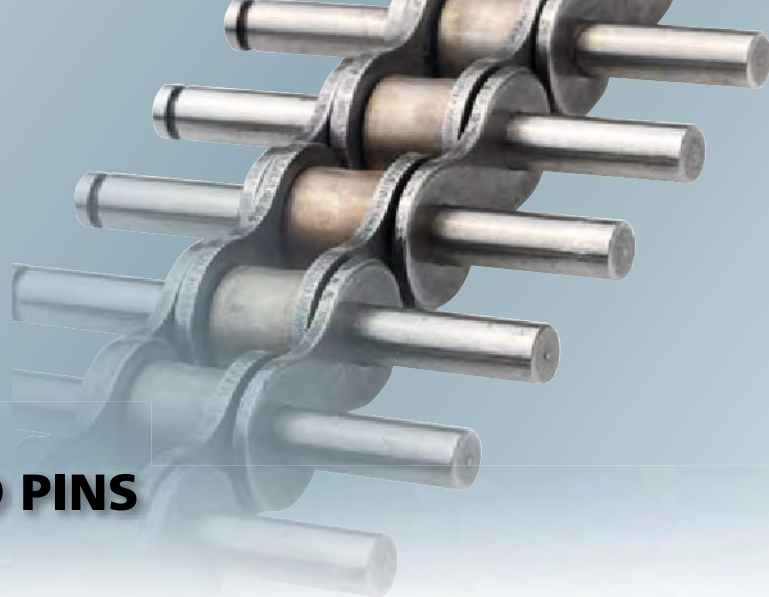

SIMPLEX ROLLER CHAINS WITH BOTH SIDE EXTENDED PINS

ČZ Standard

With on both sides extended pins

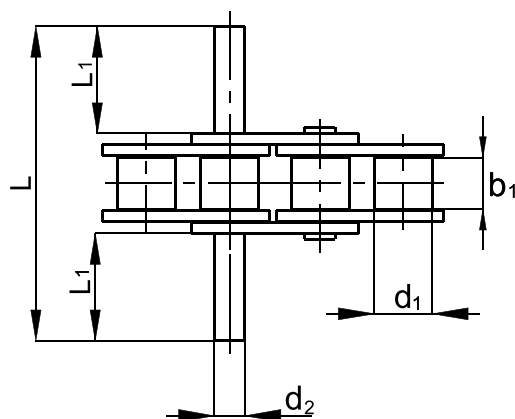
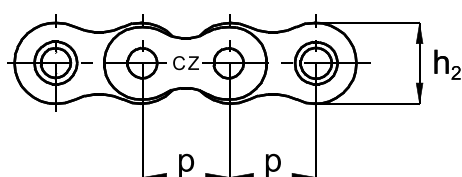

With every on both sides extended pins

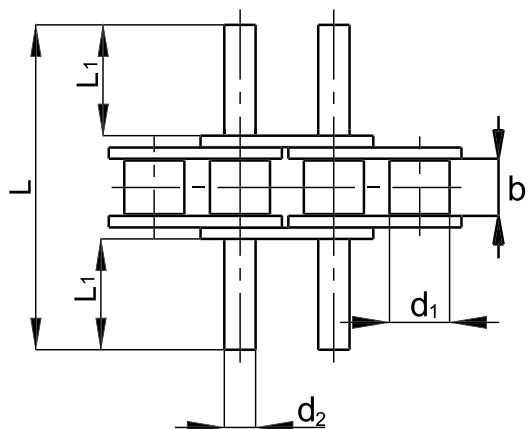
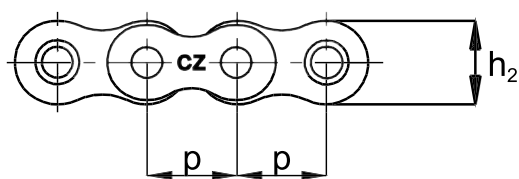

TRADE MARK ČZ	PITCH	INSIDE WIDTH	ROLLER DIAMETER	PIN DIAMETER	PIN LENGHT	PIN EXTENSION	INNER PLATE WIDTH
	p	b1 min.	d1 max.	d2 max.	L max.	L1 max.	h2 max.
	mm	mm	mm	mm	mm	mm	mm
06 B-1*	9,525	5,72	6,35	3,28	22,65	6,00	8,20
06 B-1*	9,525	5,72	6,35	3,28	32,90	11,00	8,20
06 B-1*	9,525	5,72	6,35	3,30	14,90	1,80	8,20
081	12,7	3,30	7,75	3,66	13,20	2,50	9,90
1/2"x3/16" VELO	12,7	4,88	7,75	3,66	11,50	1,00	9,90
1/2"x3/16" MOFA	12,7	4,88	7,75	4,09	14,00	1,35	10,90
1/2"x3/16" MOFA	12,7	4,88	7,75	4,18	33,70	11,25	10,90
08 B-1	12,7	7,75	8,51	4,45	17,60	1,60	11,80
08 B-1	12,7	7,75	8,51	4,45	18,20	1,80	11,80
08 B-1	12,7	7,75	8,51	4,45	19,00	2,20	11,80
08 B-1	12,7	7,75	8,51	4,45	30,45	7,95	11,80
08 B-1	12,7	7,75	8,51	4,45	40,55	13,00	11,80

SIMPLEX ROLLER CHAINS WITH BOTH SIDE EXTENDED PINS

ČZ Standard

TRADE MARK ČZ	PITCH	INSIDE WIDTH	ROLLER DIAMETER	PIN DIAMETER	PIN LENGHT	PIN EXTENSION	INNER PLATE WIDTH
	p	b1 min.	d1 max.	d2 max.	L max.	L1 max.	h2 max.
	mm	mm	mm	mm	mm	mm	mm
08 B-1	12,7	7,75	8,51	4,45	44,25	14,80	11,80
08 B-1	12,7	7,75	8,51	4,45	55,65	20,55	11,80
101	15,875	6,48	10,16	5,08	18,70	2,60	14,50
10 A-1	15,875	9,53	10,16	5,08	40,00	11,00	14,50
10 B-1	15,875	9,65	10,16	5,08	26,10	4,70	14,50
10 B-1	15,875	9,65	10,16	5,08	35,30	9,20	14,50
10 B-1	15,875	9,65	10,16	5,08	51,90	17,60	14,50
12 B-1	19,05	11,68	12,07	5,72	25,60	3,00	16,10
12 B-1	19,05	11,68	12,07	5,72	41,75	11,00	16,10
12 B-1	19,05	11,68	12,07	5,72	61,25	20,80	16,10
16 B-1	25,4	17,02	15,88	8,28	39,80	3,90	21,00
16 B-1	25,4	17,02	15,88	8,28	67,30	17,60	21,00
16 B-1	25,4	17,02	15,88	8,28	97,50	32,70	21,00
16 B-1	25,4	17,02	15,88	8,28	99,10	33,60	21,00
212 B	38,1	11,68	12,07	5,72	41,75	11,00	16,40

*Only with straight plates



DUPLEX ROLLER CHAINS WITH ONE SIDE EXTENDED PINS

ČZ Standard

With single extended pins

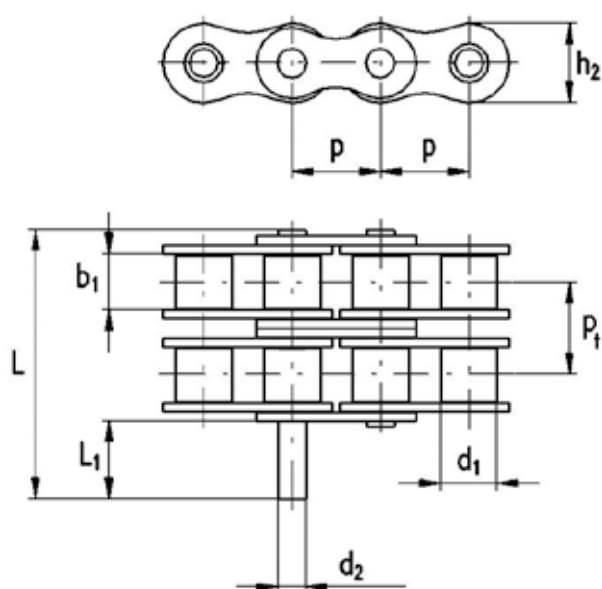

With all pins extended

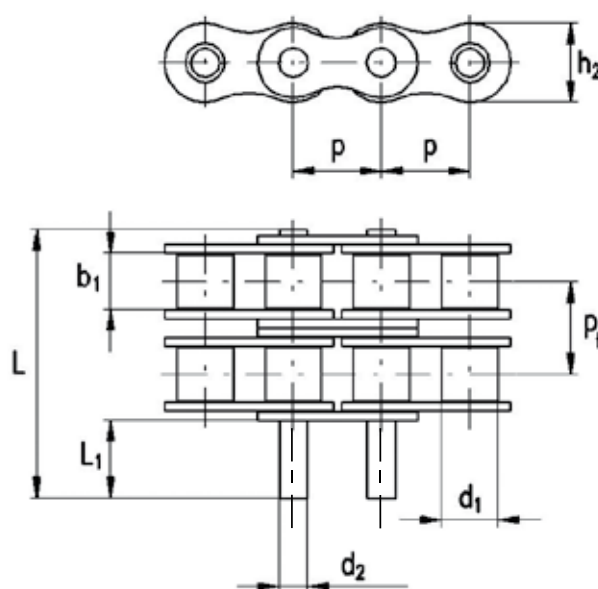

TRADE MARK ČZ	PITCH	INSIDE WIDTH	ROLLER DIAMETER	TRANSVER. PITCH	PIN DIAMETER	PIN LENGTH	PIN EXTENSION	INNER PLATE WIDTH
	p	b1 min.	d1 max.	Pt	d2 max.	L max.	L1 max.	h2 max.
	mm	mm	mm	mm	mm	mm	mm	mm
06 B-2*+	9,525	5,72	6,35	10,24	3,28	32,90	11,00	8,20
08 B-2	12,7	7,75	8,51	13,92	4,45	44,25	14,80	11,80
08 B-2	12,7	7,75	8,51	13,92	4,45	55,65	26,20	11,80
10 B-2	15,875	9,65	10,16	16,59	5,08	51,90	17,60	14,50
12 B-2	19,05	11,68	12,07	19,46	5,72	61,25	20,80	16,10
12 B-2	19,05	11,68	12,07	19,47	5,72	81,10	40,60	16,10

*ONLY WITH STRAIGHT PLATES
+ONLY WITH ONE MIDDLE PLATE

TRIPLEX ROLLER CHAINS WITH ONE SIDE EXTENDED PINS

ČZ Standard

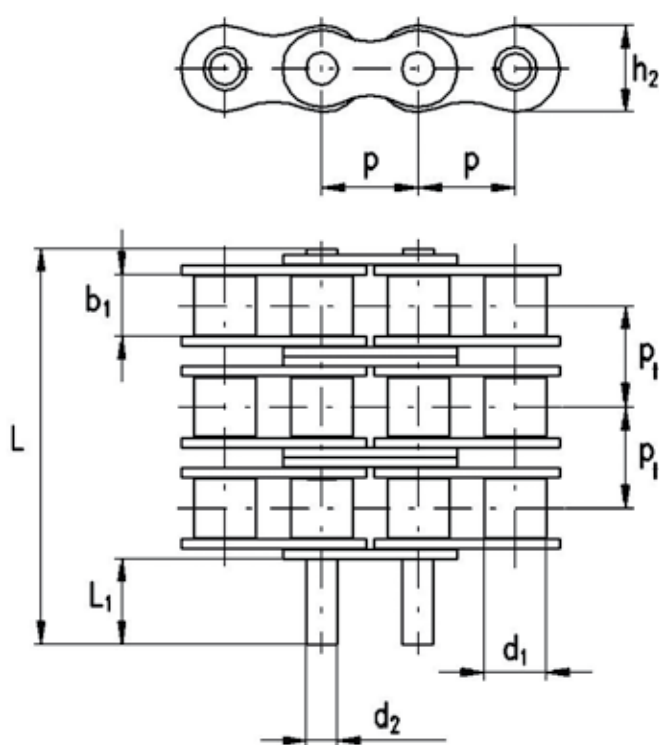

TRADE MARK ČZ	PITCH	INSIDE WIDTH	ROLLER DIAMETER	TRANSVER. PITCH	PIN DIAMETER	PIN LENGHT	PIN EXTENSION	INNER PLATE WIDTH
	p	b1 min.	d1 max.	Pt	d2 max.	L max.	L1 max.	h2 max.
	mm	mm	mm	mm	mm	mm	mm	mm
08 B-3	12,7	7,75	8,51	13,92	4,45	58,20	14,80	11,80
12 A-3	19,05	12,70	11,91	22,78	5,94	84,60	14,30	17,70



SIMPLEX ROLLER CHAINS WITH EXTENDED SHOULDERED PINS

ČZ Standard

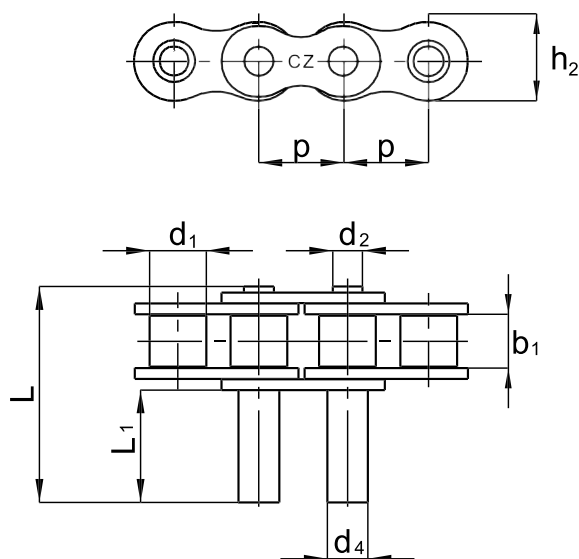

TRADE MARK ČZ	PITCH	INSIDE WIDTH	ROLLER DIAMETER	PIN DIAMETER	SHOULDER DIAMETER	PIN LENGHT	PIN EXTENSION	INNER PLATE WIDTH
	p	b1 min.	d1 max.	d2 max.	d4	L max.	L1 max.	h2 max.
	mm	mm	mm	mm	mm	mm	mm	mm
06 B-1*	9,525	5,72	6,35	3,28	4,55	28,00	16,50	8,20
06 B-1*	9,525	5,72	6,35	3,28	5,08	26,60	15,00	8,20
06 B-1*	9,525	5,72	6,35	3,28	5,08	31,50	20,00	8,20
081	12,7	3,30	7,75	3,66	4,44	22,20	13,50	9,90
081	12,7	3,30	7,75	3,66	4,45	25,50	16,50	9,90
081	12,7	3,30	7,75	3,66	4,55	31,30	22,30	9,90
081	12,7	3,30	7,75	3,66	5,00	24,00	15,00	9,90
081	12,7	3,30	7,75	3,66	5,00	33,00	24,00	9,90
081	12,7	3,30	7,75	3,66	5,17	24,00	15,00	9,90
081	12,7	3,30	7,75	3,66	5,17	31,00	22,00	9,90
410	12,7	3,30	7,75	3,66	5,00	33,00	24,00	9,90
1/2"x3/16" MOFA	12,7	4,88	7,75	4,18	5,00	35,60	23,50	10,90
08 B-1	12,7	7,75	8,51	4,45	3,90	25,60	10,00	11,80
08 B-1	12,7	7,75	8,51	4,45	4,90	21,55	5,00	11,80
08 B-1	12,7	7,75	8,51	4,45	5,00	50,55	35,00	11,80
08 B-1	12,7	7,75	8,51	4,45	5,17	31,80	15,00	11,80

*Only with straight plates

SIMPLEX ROLLER CHAINS WITH EXTENDED SHOULDERED PINS

ČZ Standard

TRADE MARK ČZ	PITCH	INSIDE WIDTH	ROLLER DIAMETER	PIN DIAMETER	SHOULDER DIAMETER	PIN LENGHT	PIN EXTENSION	INNER PLATE WIDTH
	p	b1 min.	d1 max.	d2 max.	d4	L max.	L1 max.	h2 max.
	mm	mm	mm	mm	mm	mm	mm	mm
08 B-1	12,7	7,75	8,51	4,45	6,00	31,05	15,50	11,80
08 B-1	12,7	7,75	8,51	4,45	6,06	23,55	8,00	11,80
08 B-1	12,7	7,75	8,51	4,45	6,06	30,90	15,30	11,80
08 B-1	12,7	7,75	8,51	4,45	6,06	35,55	20,00	11,80
08 B-1	12,7	7,75	8,51	4,45	6,06	37,10	21,60	11,80
08 B-1	12,7	7,75	8,51	4,45	8,00	35,55	20,00	11,80
428	12,7	7,75	8,51	4,45	5,17	31,80	15,00	12,00
10 B-1	15,875	9,65	10,16	5,08	5,50	35,30	17,50	14,50
10 B-1	15,875	9,65	10,16	5,08	5,50	37,80	20,00	14,50
10 B-1	15,875	9,65	10,16	5,08	6,06	33,85	16,00	14,50
10 B-1	15,875	9,65	10,16	5,08	6,06	68,80	51,00	14,50
10 B-1	15,875	9,65	10,16	5,08	6,60	37,80	20,00	14,50
10 B-1	15,875	9,65	10,16	5,08	8,00	37,70	20,00	14,50
10 B-1	15,875	9,65	10,16	5,08	8,00	44,80	27,00	14,50
10 B-1	15,875	9,65	10,16	5,08	8,00	57,80	40,00	14,50
10 B-1	15,875	9,65	10,16	5,08	10,00	32,80	15,00	14,50
10 B-1	15,875	9,65	10,16	5,08	10,00	43,00	25,20	14,50
12 B-1	19,05	11,68	12,07	5,72	5,90	33,20	12,20	16,10
12 B-1	19,05	11,68	12,07	5,72	6,90	80,30	40,00	16,10
12 B-1	19,05	11,68	12,07	5,72	7,00	41,00	20,00	16,10
12 B-1	19,05	11,68	12,07	5,72	7,00	47,00	26,00	16,10
12 B-1	19,05	11,68	12,07	5,72	7,00	51,00	30,00	16,10
12 B-1	19,05	11,68	12,07	5,72	7,00	52,70	31,70	16,10
12 B-1	19,05	11,68	12,07	5,72	8,00	47,00	26,00	16,10
12 B-1	19,05	11,68	12,07	5,72	8,00	56,00	35,00	16,10
12 B-1	19,05	11,68	12,07	5,72	8,00	61,40	40,40	16,10
12 B-1	19,05	11,68	12,07	5,72	10,00	41,00	20,00	16,10
12 B-1	19,05	11,68	12,07	5,72	10,27	41,00	20,00	16,10
16 B-1	25,4	17,02	15,88	8,28	6,00	67,30	33,60	21,00
16 B-1	25,4	17,02	15,88	8,28	9,00	67,30	33,60	21,00
16 B-1	25,4	17,02	15,88	8,28	10,00	63,80	30,00	21,00
208 B	25,4	7,75	8,51	4,45	6,06	30,90	15,30	12,00
212 B	38,1	11,68	12,07	5,72	7,00	47,00	26,00	16,40

The position of extended shouldered pins must be consulted with the producer



DUPLEX ROLLER CHAINS WITH EXTENDED SHOULDERED PINS

ČZ Standard

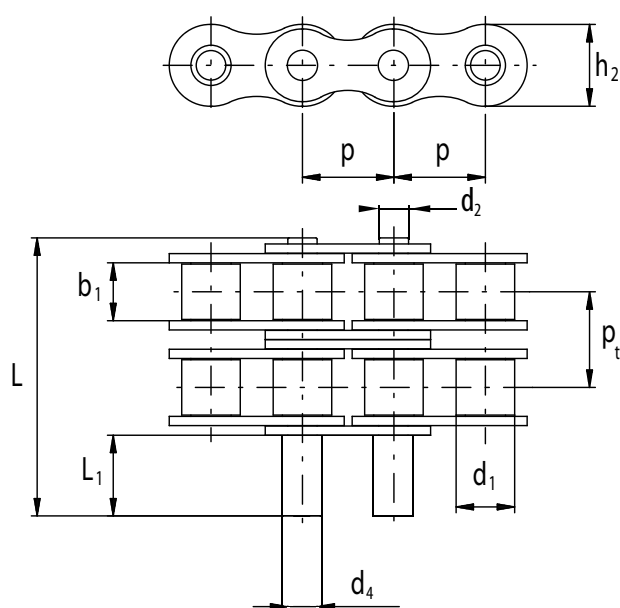

TRADE MARK ČZ	PITCH	INSIDE WIDTH	ROLLER DIAMETER	PIN DIAMETER	SHOULDER DIAMETER	PIN LENGTH	PIN EXTENSION	INNER PLATE WIDTH
	p	b1 min.	d1 max.	d2 max.	d4	L max.	L1 max.	h2 max.
	mm	mm	mm	mm	mm	mm	mm	mm
10 B-2	15,875	9,65	10,16	5,08	6,06	49,30	15,00	14,50
16 B-2	25,4	17,02	15,88	8,28	12,00	85,60	19,90	21,00

The position of extended shouldered pins must be consulted with the producer

SPECIAL EXTENDED PINS

ČZ Standard

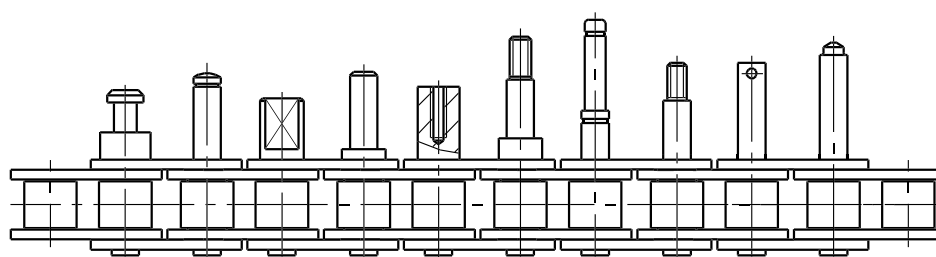

Most of roller and bush chains in single and multiple row modification can be equipped with extended pins according to individual customer request - see picture above.

The pins can be equipped with grooves for the adjusting plate or adjusting ring, they can also have a holes for cotter, outer and inner thread, spots, or they can be multiple shouldered. Dimensions of these special pins, their position and also the basic chain modification must be consulted with producer.



SIMPLEX ROLLER CHAINS WITH HOLLOW PINS

ČZ Standard

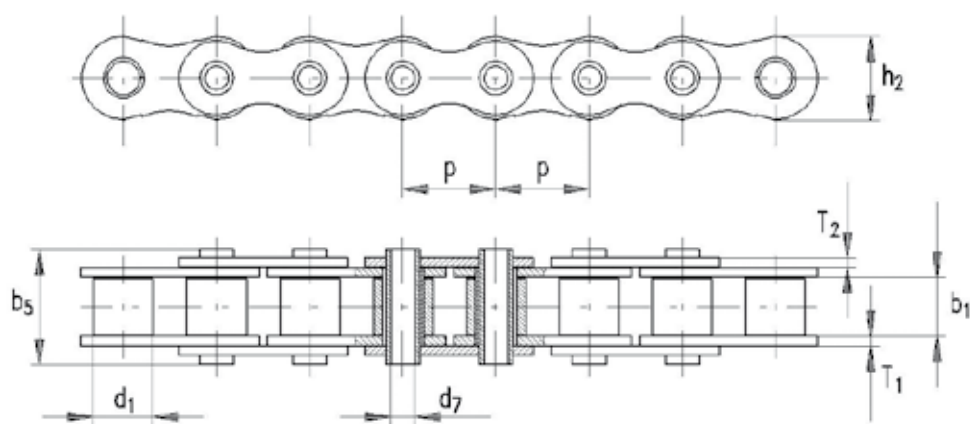

MODIFICATION 1.

TRADE MARK ČZ	PITCH	INSIDE WIDTH	ROLLER DIAMETER	HOLE DIAMETER IN THE PIN	PIN LENGHT	INNER PLATE WIDTH	INNER PLATE THICKNESS	OUTER PLATE THICKNESS	WEIGHT	BREAKING LOAD	CONNECT. ELEMENTS	
	p	b1 min.	d1 max.	d7 min.	b5 max.	h2 max.	T1	T2	q	FB min.	A	B
	mm	mm	mm	mm	mm	mm	mm	mm	kg/m	N		
12 B-1	19,05	11,68	12,07	4,10	22,30	16,10	1,80	1,80	1,09	21 700	•	•

CONNECTING ELEMENTS



B

A

SIMPLEX ROLLER CHAINS WITH HOLLOW PINS

ČZ Standard

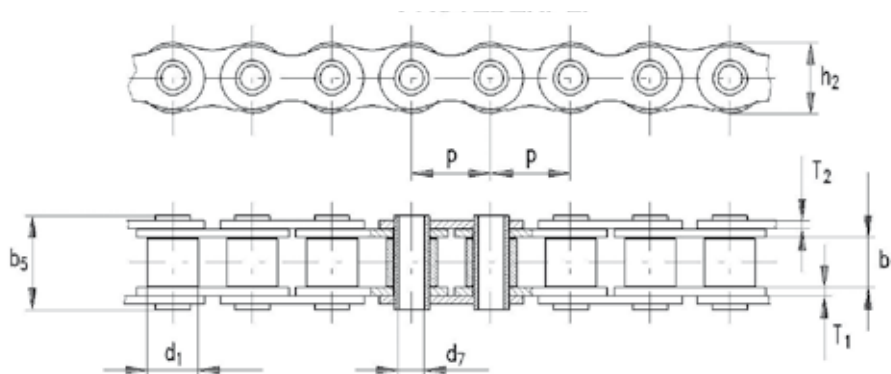

MODIFICATION 2.

TRADE MARK ČZ	PITCH	INSIDE WIDTH	ROLLER DIAMETER	HOLE DIAMETER IN THE PIN	PIN LENGTH	INNER PLATE WIDTH	INNER PLATE THICKNESS	OUTER PLATE THICKNESS	WEIGHT	BREAKING LOAD	CONNECT. ELEMENTS
	p	b1 min.	d1 max.	d7 min.	b5 max.	h2 max.	T1	T2	q	FB min.	A
	mm	mm	mm	mm	mm	mm	mm	mm	kg/m	N	
08 B-1	12,7	7,75	8,51	4,50	15,20	11,80	1,60	1,40	0,55	8 700	•
08 B-1	12,7	7,75	8,51	4,50	16,60	11,80	1,60	1,40	0,57	8 700	•
10 B-1	15,875	9,65	10,16	4,10	20,00	14,50	2,00	2,00	0,90	20 290	•
10 B-1	15,875	9,65	10,16	5,13	20,00	14,50	2,00	2,00	0,87	20 290	•
12 A-1	19,05	12,70	11,91	5,15	24,60	17,70	2,40	2,40	1,24	13 920	•
12 A-1	19,05	12,70	11,91	6,10	24,60	17,70	2,40	2,40	1,24	13 920	•

CONNECTING ELEMENTS



A



DUPLEX ROLLER CHAINS WITH HOLLOW PINS

ČZ Standard

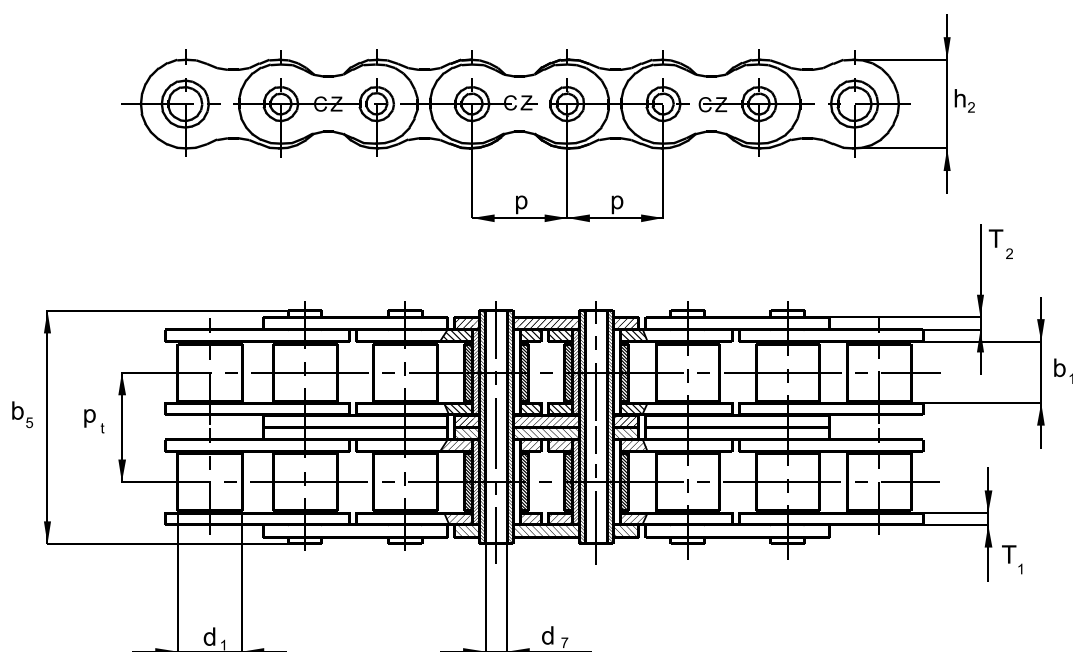

MODIFICATION 1.

TRADE MARK ČZ	PITCH	INSIDE WIDTH	ROLLER DIAMETER	HOLE DIAMETER IN THE PIN	PIN LENGTH	INNER PLATE WIDTH	INNER PLATE THICKNESS	OUTER PLATE THICKNESS	TRANSVER. PITCH	WEIGHT	BREAKING LOAD	CONNECT. ELEMENTS	
	p	b1 min.	d1 max.	d7 min.	b5 max.	h2 max.	T1	T2	Pt	q	FB min.	B	A
	mm	mm	mm	mm	mm	mm	mm	mm	mm	kg/m	N		
08 B-2	12,70	7,75	8,51	3,20	30,90	11,80	1,60	1,40	13,92	1,22	32 655	•	•

CONNECTING ELEMENTS

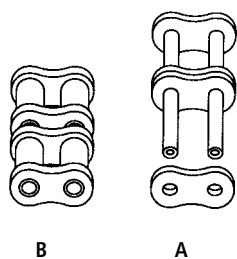

B

A

DUPLEX ROLLER CHAINS WITH HOLLOW PINS

ČZ Standard

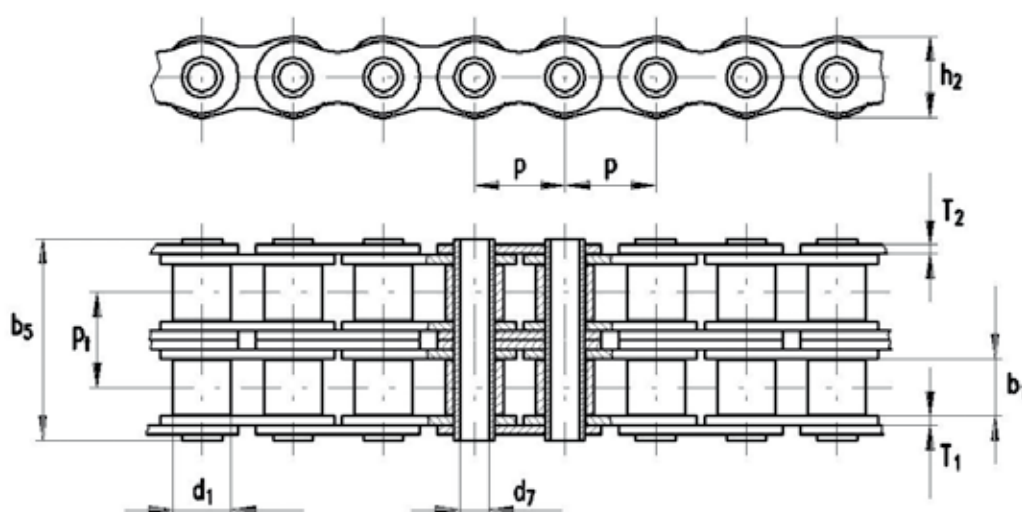

MODIFICATION 2.

TRADE MARK ČZ	PITCH	INSIDE WIDTH	ROLLER DIAMETER	HOLE DIAMETER IN THE PIN	PIN LENGHT	INNER PLATE WIDTH	INNER PLATE THICKNESS	OUTER PLATE THICKNESS	TRANSVER. PITCH	WEIGHT	BREAKING LOAD	CONNECT. ELEMENTS
	p	b1 min.	d1 max.	d7 min.	b5 max.	h2 max.	T1	T2	Pt	q	FB min.	A
	mm	mm	mm	mm	mm	mm	mm	mm	mm	kg/m	N	
12 A-2	19,05	12,70	11,91	6,05	48,65	17,70	2,40	2,40	22,78	2,27	25 000	.

CONNECTING ELEMENTS

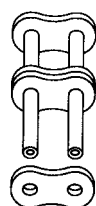

A



SIMPLEX ROLLER CHAINS WITH EXTENDED BARS

ČZ Standard

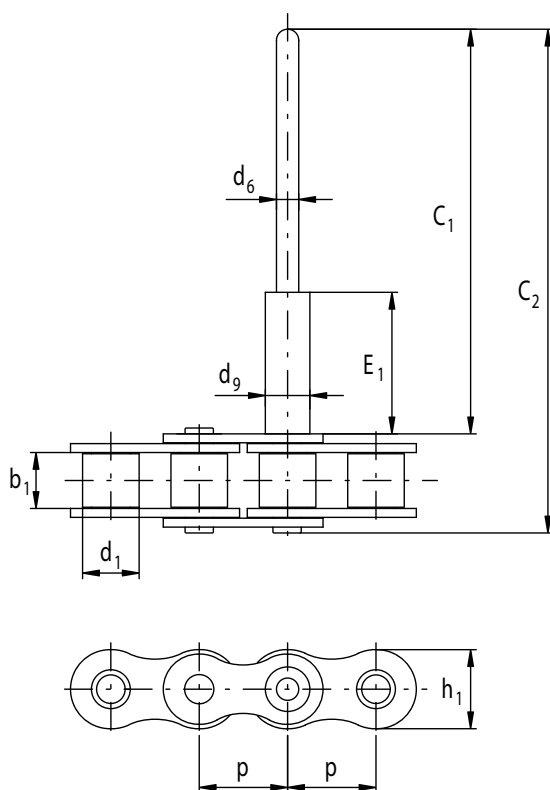

TRADE MARK ČZ	PITCH	INSIDE WIDTH	ROLLER DIAMETER	CONNECTING ELEMENT DIAMETER	BAR EXTENSION	CONNECTING LINK LENGTH	BAR EXTENSION	WHOLE LENGTH	INNER PLATE WIDTH
	p	b1 min.	d1 max.	d9	d6	E1	C1	C2	h2 max.
	mm	mm	mm	mm	mm	mm	mm	mm	mm
08 B-1	12,7	7,75	8,51	8,00	3,97	22,00	175,00	190,50	11,80
10 B-1	15,875	9,65	10,16	8,00	4,00	35,00	246,00	264,00	14,50
10 B-1	15,875	9,65	10,16	8,00	3,97	35,00	242,00	260,00	14,50
10 B-1	15,875	9,65	10,16	8,00	3,00	22,00	160,00	177,70	14,50
12 B-1	19,05	11,68	12,07	9,00	4,00	22,00	273,00	294,00	16,10
12 B-1	19,05	11,68	12,07	9,00	3,97	22,00	232,00	253,00	16,10
12 B-1	19,05	11,68	12,07	9,00	3,97	22,00	278,00	299,00	16,10

Bars position must be consulted with producer

According to customer request a dural extender can be press on the bar end

ROLLER CHAINS WITH ROTARY BUSHES

ČZ Standard

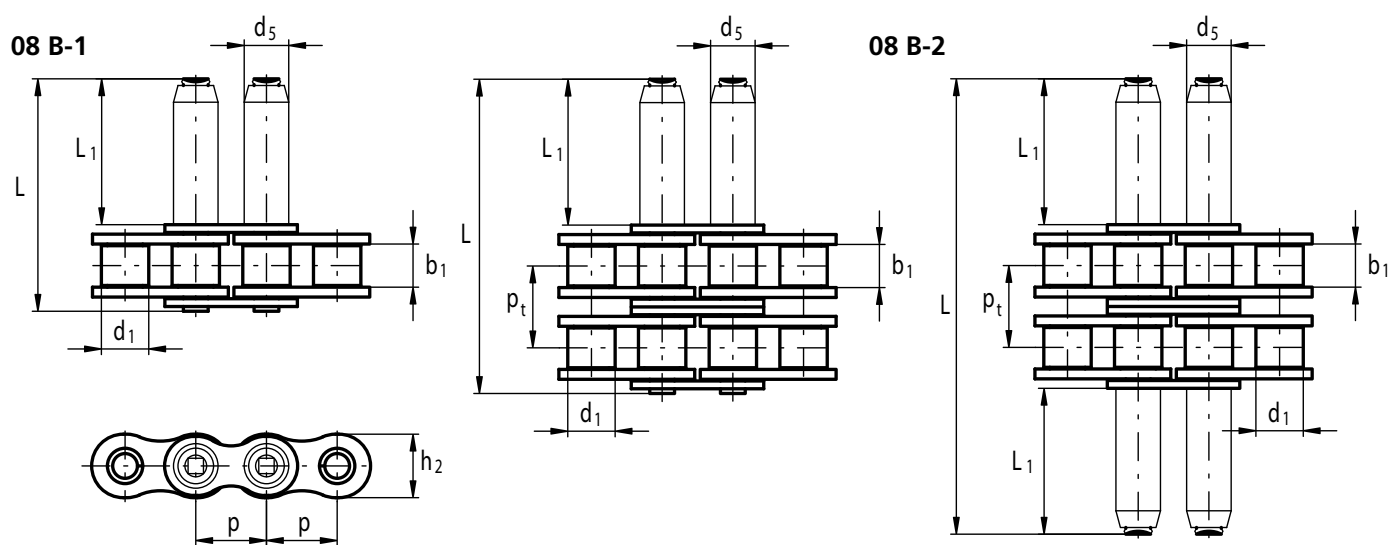

TRADE MARK ČZ	PITCH	INSIDE WIDTH	ROLLER DIAMETER	BUSH DIAMETER	PIN LENGHT	PIN EXTENSION	TRANSVER. PITCH	INNER PLATE WIDTH	BUSHES POSITIONING
	p	b1 min.	d1 max.	d5	L max.	L1 max.	pt	h2 max.	
	mm	mm	mm	mm	mm	mm	mm	mm	
08 B-1	12,7	7,75	8,51	8,00	41,80	26,20	-	11,80	one side
08 B-2	12,7	7,75	8,51	8,00	55,65	26,20	13,92	11,80	one side
08 B-2	12,7	7,75	8,51	8,00	80,85	26,20	13,92	11,80	both sides



CONVEYOR CHAIN BELTS

ČZ Standard

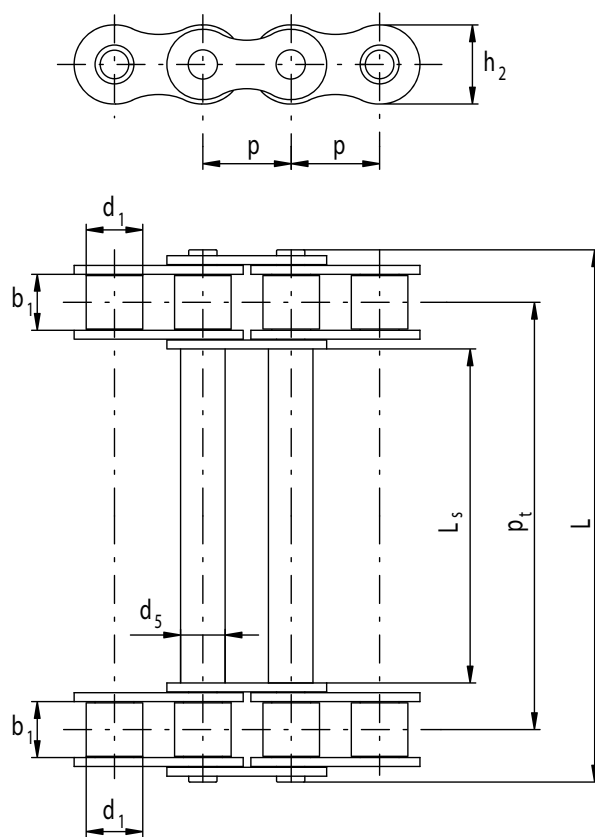

TRADE MARK ČZ	PITCH	INSIDE WIDTH	ROLLER DIAMETER	CONNECTING ELEMENT DIAMETER	WIDTH BETWEEN THE CHAINS	TRANSVERSAL PITCH	PIN LENGHT	INNER PLATE WIDTH
	p	b1 min.	d1 max.	d5	Ls	pt	L max.	h2 max.
	mm	mm	mm	mm	mm	mm	mm	mm
08 B	12,7	7,75	8,51	8,50	30,80	45,50	62,00	11,80
10 B1)	15,875	9,65	10,16	8,00	60,00	76,75	99,10	14,50
12 B	19,05	11,68	12,07	7,50	50,50	70,00	92,30	16,10

1) ONLY WITH SPECIAL CONNECTING ELEMENT

The connecting items can be positioned according to individual customer request - must be consulted with producer