

Figur 1F

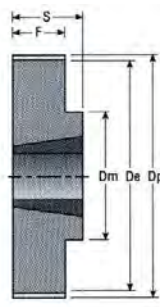

Figur 2

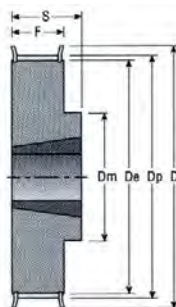

Figur 2F

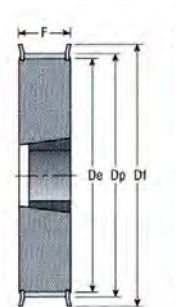

Figur 3F

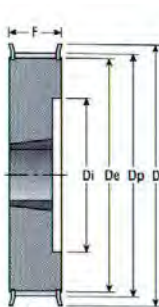

Figur 5F



Typ PC 8M - Pro řemeny PC GT a CTD Synchrochain 8M / For belts PC GT and CTD Synchrochain 8M

Zubů Teeth	Šíř.ř. Width	Označení / Obj.č. Part.No.	Typ Fig.	* Mat.	Pouzdro Bush	Max.díra Max.Bore	Dp [mm]	De [mm]	Df [mm]	Dm [mm]	Di [mm]	F [mm]	S [mm]	R [mm]	m [kg]
22	12	8M-22-S12	1F	ST	PB12	28,0	56,02	54,42	62,0	43,0	-	20,0	30,0	-	0,42
21	12	8M-22-S21	1F	ST	PB12	28,0	56,02	54,42	62,0	43,0	-	30,0	40,0	-	0,57
25	12	8M-25-S12	2F	GG	1108	28,0	63,66	62,06	70,0	49,0	-	20,0	22,0	-	0,43
21	12	8M-25-S21	3F	GG	1108	28,0	63,66	62,06	70,0	-	-	30,0	22,0	8,0	0,60
36	12	8M-25-S36	1F	ST	PB12	32,0	63,66	62,06	70,0	49,0	-	45,0	55,0	-	1,02
28	12	8M-28-S12	2F	GG	1108	28,0	71,30	69,70	79,0	59,0	-	20,0	22,0	-	0,60
21	12	8M-28-S21	3F	ST	1210	32,0	71,30	69,70	79,0	-	-	30,0	25,0	5,0	0,75
36	12	8M-28-S36	3F	ST	1210	32,0	71,30	69,70	79,0	-	-	45,0	25,0	20,0	1,11
30	12	8M-30-S12	2F	GG	1210	32,0	76,39	74,79	86,0	66,0	-	20,0	25,0	-	0,67
21	12	8M-30-S21	3F	ST	1210	32,0	76,39	74,79	86,0	-	-	30,0	25,0	5,0	0,83
36	12	8M-30-S36	3F	ST	1610	42,0	76,39	74,79	86,0	-	-	45,0	25,0	20,0	1,22
62	12	8M-30-S62	1F	ST	PB20	42,0	76,39	74,79	86,0	65,0	-	72,0	84,0	-	2,45
32	12	8M-32-S12	2F	GG	1610	42,0	81,49	79,89	90,0	66,0	-	20,0	25,0	-	0,77
21	12	8M-32-S21	3F	ST	1610	42,0	81,49	79,89	90,0	-	-	30,0	25,0	5,0	0,97
36	12	8M-32-S36	3F	ST	1610	42,0	81,89	79,89	90,0	-	-	45,0	25,0	20,0	1,45
62	12	8M-32-S62	1F	ST	PB20	50,0	81,49	79,89	90,0	69,0	-	72,0	84,0	-	2,82
34	12	8M-34-S12	2F	GG	1610	42,0	86,58	84,98	95,0	70,0	-	20,0	25,0	-	0,88
21	12	8M-34-S21	3F	GG	1610	42,0	86,58	84,98	95,0	-	-	30,0	25,0	5,0	1,12
36	12	8M-34-S36	3F	GG	1610	42,0	86,58	84,98	95,0	-	-	45,0	25,0	20,0	1,66
62	12	8M-34-S62	1F	ST	PB20	55,0	86,58	84,98	95,0	74,0	-	72,0	84,0	-	3,17
36	12	8M-36-S12	2F	GG	1610	42,0	91,67	90,07	98,0	78,0	-	20,0	25,0	-	1,02
21	12	8M-36-S21	3F	GG	1610	42,0	91,67	90,07	98,0	-	-	30,0	25,0	5,0	1,29
36	12	8M-36-S36	3F	GG	1610	42,0	91,67	90,07	98,0	-	-	45,0	25,0	20,0	1,90
62	12	8M-36-S62	1F	ST	PB20	60,0	91,67	90,07	98,0	77,0	-	72,0	84,0	-	3,52
38	12	8M-38-S12	2F	GG	1610	42,0	96,77	95,17	106,0	80,0	-	20,0	25,0	-	1,15
21	12	8M-38-S21	3F	GG	1610	42,0	96,77	95,17	106,0	-	-	30,0	25,0	5,0	1,34
36	12	8M-38-S36	3F	GG	1610	42,0	96,77	95,17	106,0	-	-	45,0	25,0	20,0	2,21
62	12	8M-38-S62	1F	ST	PB20	60,0	96,77	95,17	106,0	84,0	-	72,0	84,0	-	3,91
40	12	8M-40-S12	2F	GG	1610	42,0	101,86	100,26	111,0	85,0	-	20,0	25,0	-	1,19
21	12	8M-40-S21	3F	GG	1610	42,0	101,86	100,26	111,0	-	-	30,0	25,0	5,0	1,50
36	12	8M-40-S36	3F	ST	2012	50,0	101,86	100,26	111,0	-	-	45,0	32,0	13,0	2,36
62	12	8M-40-S62	3F	GG	2012	50,0	101,86	100,26	111,0	-	-	72,0	32,0	40,0	3,76
45	12	8M-45-S12	2F	GG	2012	50,0	114,59	112,99	119,0	92,0	-	20,0	32,0	-	1,76
21	12	8M-45-S21	2F	GG	2012	50,0	114,59	112,99	119,0	92,0	-	30,0	32,0	-	2,03
36	12	8M-45-S36	3F	GG	2012	50,0	114,59	112,99	119,0	-	-	45,0	32,0	13,0	3,07
62	12	8M-45-S62	3F	GG	2012	50,0	114,59	112,99	119,0	-	-	72,0	32,0	40,0	4,88
48	12	8M-48-S12	2F	GG	2012	50,0	122,23	120,63	135,0	104,0	-	20,0	32,0	-	2,16
21	12	8M-48-S21	2F	GG	2012	50,0	122,23	120,63	135,0	104,0	-	30,0	32,0	-	2,24
36	12	8M-48-S36	3F	GG	2012	50,0	122,23	120,63	135,0	-	-	45,0	32,0	13,0	3,30
62	12	8M-48-S62	3F	GG	2517	60,0	122,23	120,63	135,0	-	-	72,0	45,0	27,0	5,52

* Materiál: ST = ocel, GG = litina / ST = steel, GG = iron cast

PB.. = s předvrtanou dírou d=.. / PB = Min.plain bore

TYMA CZ, s.r.o., Tel: +420 475 655 010, Fax: +420 475 655 018, e-mail: info@tyma.cz, www.tyma.cz, www.remeny-online.com

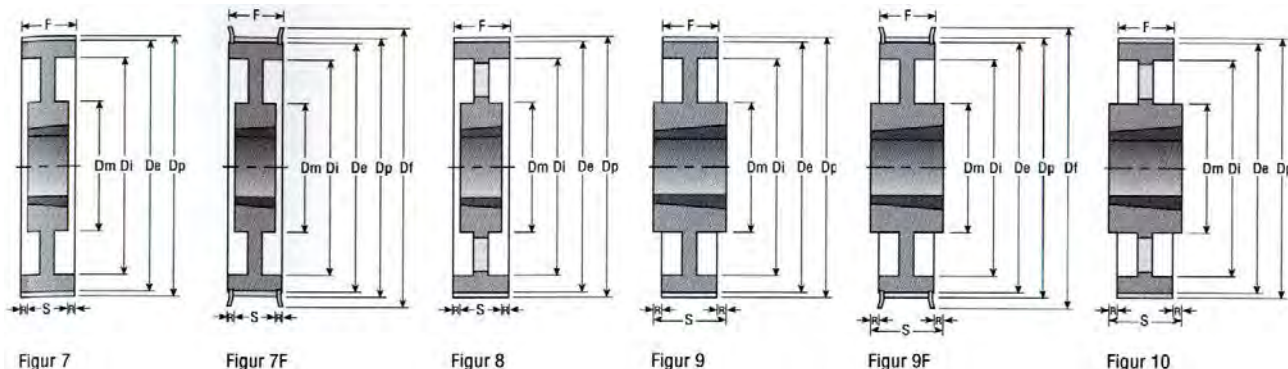

Typ PC 8M - Pro řemeny PC GT a CTD Synchrochain 8M / For belts PC GT and CTD Synchrochain 8M

Zubů Teeth	Šíř.ř. Width	Označení / Obj.č. Part.No.	Typ Fig.	* Mat. Mat.	Pouzdří Bush	Max.díra Max.Bore	Dp [mm]	De [mm]	Df [mm]	Dm [mm]	Di [mm]	F [mm]	S [mm]	R [mm]	m [kg]
50	12	8M-50-S12	2F	GG	2012	50,0	127,32	125,72	135,0	104,0	-	20,0	32,0	-	2,16
	21	8M-50-S21	2F	GG	2012	50,0	127,32	125,72	135,0	104,0	-	30,0	32,0	-	2,42
	36	8M-50-S36	3F	GG	2012	50,0	127,32	125,72	135,0	-	-	45,0	32,0	13,0	3,58
	62	8M-50-S62	3F	GG	2517	60,0	127,32	125,72	135,0	-	-	72,0	45,0	27,0	6,03
56	12	8M-56-S12	2F	GG	2012	50,0	142,60	141,00	151,0	104,0	-	20,0	32,0	-	2,83
	21	8M-56-S21	2F	GG	2012	50,0	142,60	141,00	151,0	111,0	-	30,0	32,0	-	3,20
	36	8M-56-S36	3F	GG	2517	60,0	142,60	141,00	151,0	-	-	45,0	45,0	0,0	4,48
	62	8M-56-S62	6F	GG	2517	60,0	142,60	141,00	151,0	-	111,0	72,0	45,0	13,5	5,43
60	12	8M-60-S12	2F	GG	2012	50,0	152,79	151,19	159,0	111,0	-	20,0	32,0	-	3,24
	21	8M-60-S21	2F	GG	2517	60,0	152,79	151,19	159,0	124,0	-	30,0	45,0	-	4,66
	36	8M-60-S36	3F	GG	2517	60,0	152,79	151,19	159,0	-	-	45,0	45,0	0,0	5,30
	62	8M-60-S62	6F	GG	2517	60,0	152,79	151,19	159,0	-	121,0	72,0	45,0	13,5	6,33
64	12	8M-64-S12	2F	GG	2012	50,0	162,97	161,37	168,0	111,0	-	20,0	32,0	-	3,51
	21	8M-64-S21	2F	GG	2517	60,0	162,97	161,37	168,0	124,0	-	30,0	45,0	-	5,28
	36	8M-64-S36	3F	GG	2517	60,0	162,97	161,37	168,0	-	-	45,0	45,0	0,0	6,19
	62	8M-64-S62	6F	GG	2517	60,0	162,97	161,37	168,0	-	131,0	72,0	45,0	13,5	7,11
75	12	8M-75-S12	2	GG	2012	50,0	190,99	189,39	-	111,0	-	20,0	32,0	-	4,57
	21	8M-75-S21	2	GG	2517	60,0	190,99	189,39	-	124,0	-	30,0	45,0	-	6,77
	36	8M-75-S36	2	GG	3020	75,0	190,99	189,39	-	150,0	-	45,0	51,0	-	8,72
	62	8M-75-S62	6	GG	3020	75,0	190,99	189,39	-	-	159,0	72,0	51,0	10,5	9,99
80	12	8M-80-S12	2	GG	2012	50,0	203,72	202,12	-	111,0	-	20,0	32,0	-	5,13
	21	8M-80-S21	2	GG	2517	60,0	203,72	202,12	-	124,0	-	30,0	45,0	-	7,61
	36	8M-80-S36	2	GG	3020	75,0	203,72	202,12	-	150,0	-	45,0	51,0	-	9,96
	62	8M-80-S62	6	GG	3020	45,0	203,72	202,12	-	-	172,0	72,0	51,0	10,5	
90	12	8M-90-S12	2	GG	2012	50,0	229,18	227,58	-	111,0	-	20,0	-	-	6,37
	21	8M-90-S21	9	GG	2517	60,0	229,18	227,58	-	124,0	198,0	30,0	45,0	7,5	8,57
	36	8M-90-S36	9	GG	3020	75,0	229,18	227,58	-	150,0	197,0	45,0	51,0	3,0	10,41
	62	8M-90-S62	6	GG	3020	75,0	229,18	227,58	-	-	197,0	72,0	51,0	10,5	14,94
112	21	8M-112-S21	9	GG	2517	60,0	285,21	283,61	-	124,0	253,0	30,0	45,0	7,5	12,50
	36	8M-112-S36	9	GG	3020	75,0	285,21	283,61	-	150,0	253,0	45,0	51,0	3,0	14,01
	62	8M-112-S62	7	GG	3020	75,0	285,21	283,61	-	150,0	253,0	72,0	51,0	10,5	14,94
140	21	8M-140-S21	10	GG	3020	75,0	356,51	354,91	-	150,0	324,0	30,0	51,0	10,5	12,79
	36	8M-140-S36	10	GG	3020	75,0	356,51	354,91	-	150,0	324,0	45,0	51,0	3,0	11,98
	62	8M-140-S62	7	GG	3525	100,0	356,51	354,91	-	198,0	324,0	72,0	65,0	3,5	24,77
168	36	8M-168-S36	10	GG	3525	100,0	427,81	426,21	-	198,0	396,0	45,0	65,0	10,0	23,91
	62	8M-168-S62	8	GG	3525	100,0	427,81	426,21	-	198,0	396,0	72,0	65,0	3,5	28,39
192	36	8M-192-S36	10	GG	3525	100,0	488,92	487,32	-	198,0	457,0	45,0	65,0	10,0	26,53
	62	8M-192-S62	8	GG	3525	100,0	488,92	487,32	-	198,0	457,0	72,0	65,0	3,5	32,18

* Materiál: ST = ocel, GG = litina / ST = steel, GG = iron cast

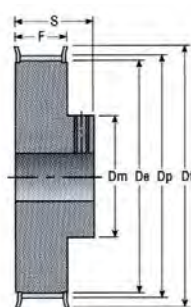

Figur 1F

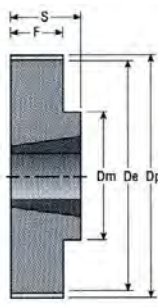

Figur 2

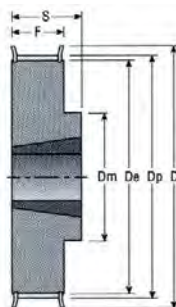

Figur 2F

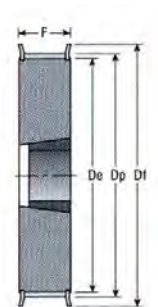

Figur 3F

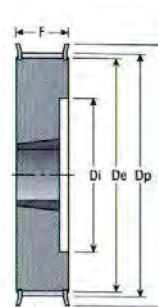

Figur 5F



Typ PC 14M - Pro řemeny PC GT a CTD Synchrochain 14M / For belts PC GT and CTD Synchrochain 14M

Zubů Teeth	Šíř.ř. Width	Označení / Obj.č. Part.No.	Typ Fig.	* Mat.	Pouzdro Bush	Max.díra Max.Bore	Dp [mm]	De [mm]	Df [mm]	Dm [mm]	Di [mm]	F [mm]	S [mm]	R [mm]	m [kg]
28	20	14M-28-S20	3F	GG	2012	50,0	124,78	121,98	141,0	-	-	33,0	32,0	1,0	2,46
37	37	14M-28-S37	5F	GG	2012	50,0	124,78	121,98	141,0	-	88,0	51,0	32,0	19,0	2,97
30	20	14M-30-S20	3F	GG	2012	50,0	133,69	130,89	141,0	-	-	33,0	32,0	1,0	2,85
37	37	14M-30-S27	6F	GG	2517	60,0	133,69	130,89	141,0	-	98,0	51,0	45,0	3,0	3,81
32	20	14M-32-S20	3F	GG	2012	50,0	142,60	139,80	155,0	-	-	33,0	32,0	1,0	3,26
27	27	14M-32-S37	6F	GG	2517	60,0	142,60	139,80	155,0	-	100,0	51,0	45,0	3,0	4,53
34	20	14M-34-S20	2F	GG	2517	60,0	151,52	148,72	162,0	117,0	-	33,0	45,0	-	4,35
37	37	14M-34-S37	6F	GG	2517	60,0	151,52	148,72	162,0	-	109,0	51,0	45,0	3,0	5,06
68	68	14M-34-S68	1F	GG	PB40	100,0	151,52	148,72	162,0	134,0	-	84,0	104,0	-	6,25
36	20	14M-36-S20	2F	GG	2517	60,0	160,43	157,53	168,0	117,0	-	33,0	45,0	-	5,05
37	37	14M-36-S37	5F	GG	2517	60,0	160,43	157,53	168,0	-	117,0	51,0	45,0	6,0	5,92
68	68	14M-36-S68	1F	GG	PB40	110,0	160,43	157,53	168,0	134,0	-	84,0	104,0	-	6,68
90	90	14M-36-S90	1F	GG	PB50	110,0	160,43	157,53	168,0	131,0	-	106,0	136,0	-	8,18
38	20	14M-38-S20	2F	GG	2517	60,0	169,34	166,54	183,0	117,0	-	33,0	45,0	-	5,39
37	37	14M-38-S37	5F	GG	2517	60,0	169,34	166,54	183,0	-	126,0	51,0	45,0	6,0	6,51
68	68	14M-38-S68	1F	GG	PB40	115,0	169,34	166,54	183,0	141,0	-	84,0	104,0	-	7,46
90	90	14M-38-S90	1F	GG	PB50	115,0	169,34	166,54	183,0	147,0	-	106,0	136,0	-	9,73
125	125	14M-38-S125	1F	GG	PB50	115,0	169,34	166,54	183,0	147,0	-	141,0	161,0	-	11,74
40	20	14M-40-S20	2F	GG	2517	60,0	178,25	175,45	197,0	117,0	-	33,0	45,0	-	5,97
37	37	14M-40-S37	5F	GG	2517	60,0	178,25	175,45	197,0	-	135,0	51,0	45,0	6,0	7,31
68	68	14M-40-S68	1F	GG	PB40	125,0	178,25	175,45	197,0	156,0	-	84,0	104,0	-	7,81
90	90	14M-40-S90	1F	GG	PB50	125,0	178,25	175,45	197,0	156,0	-	106,0	136,0	-	10,29
125	125	14M-40-S125	1F	GG	PB50	125,0	178,25	175,45	197,0	156,0	-	141,0	161,0	-	12,23
44	20	14M-44-S20	2F	GG	3020	75,0	196,08	193,28	211,0	144,0	-	33,0	51,0	-	8,03
37	37	14M-44-S37	3F	GG	3020	75,0	196,08	193,28	211,0	-	-	51,0	51,0	-	9,44
68	68	14M-44-S68	6F	GG	3020	75,0	196,08	193,28	211,0	-	153,0	84,0	51,0	16,5	11,54
90	90	14M-44-S90	1F	GG	PB50	140,0	196,08	193,28	211,0	169,0	-	106,0	136,0	-	11,92
125	125	14M-44-S125	1F	GG	PB50	140,0	196,08	193,28	211,0	170,0	-	141,0	161,0	-	14,46
48	20	14M-48-S20	2F	GG	3020	75,0	213,90	211,11	226,0	144,0	-	33,0	51,0	-	9,48
37	37	14M-48-S37	3F	GG	3020	75,0	213,90	211,11	226,0	-	-	51,0	51,0	-	11,44
68	68	14M-48-S68	5F	GG	3020	75,0	213,90	211,11	226,0	-	171,0	84,0	51,0	33,0	13,74
90	90	14M-48-S90	6F	GG	3525	100,0	213,90	211,11	226,0	-	171,0	106,0	66,0	20,0	16,76
125	125	14M-48-S125	1F	GG	PB50	160,0	213,90	211,11	226,0	185,0	-	141,0	161,0	-	14,70
50	20	14M-50-S20	2F	GG	3020	75,0	222,82	220,02	239,0	144,0	-	33,0	51,0	-	10,13
37	37	14M-50-S37	3F	GG	3020	75,0	222,82	220,02	239,0	-	-	51,0	51,0	-	12,62
68	68	14M-50-S68	6F	GG	3525	100,0	222,82	220,02	239,0	-	180,0	84,0	65,0	9,5	16,63
90	90	14M-50-S68	6F	GG	3525	100,0	222,82	220,02	239,0	-	180,0	106,0	66,0	20,0	18,38
125	125	14M-50-S125	6F	GG	3525	100,0	222,82	220,02	239,0	-	180,0	141,0	65,0	38,0	20,93
56	20	14M-56-S20	9F	GG	3020	75,0	249,55	246,76	267,0	144,0	207,0	33,0	51,0	9,0	10,81
37	37	14M-56-S37	7F	GG	3020	75,0	249,55	246,76	267,0	144,0	207,0	51,0	51,0	0,0	12,70
68	68	14M-56-S68	6F	GG	3525	100,0	249,55	246,76	267,0	-	207,0	84,0	65,0	9,5	21,15
90	90	14M-56-S90	6F	GG	3525	100,0	249,55	246,76	267,0	-	207,0	106,0	66,0	20,0	23,46
125	125	14M-56-S125	6F	GG	3525	100,0	249,55	246,76	267,0	-	207,0	141,0	65,0	38,0	25,91

* Materiál: ST = ocel, GG = litina / ST = steel, GG = iron cast

PB.. = s předvrtanou dírou d=.. / PB = Min.plain bore

TYMA CZ, s.r.o., Tel: +420 475 655 010, Fax: +420 475 655 018, e-mail: info@tyma.cz, www.tyma.cz, www.remeny-online.com

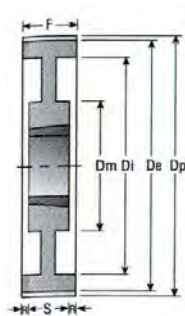

Figur 7

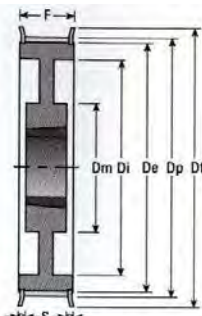

Figur 7F

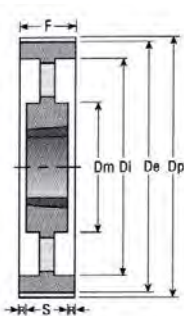

Figur 8

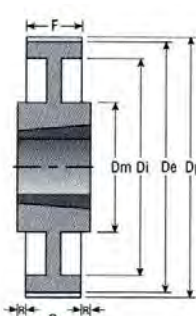

Figur 9

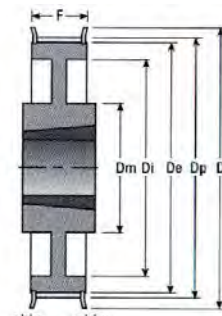

Figur 9F

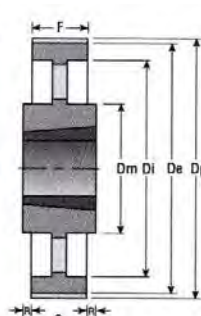

Figur 10

Typ PC 14M - Pro řemeny PC GT a CTD Synchrochain 14M / For belts PC GT and CTD Synchrochain 14M

Zubů Teeth	Šíř. Width	Označení / Obj.č. Part.No.	Typ Fig.	* Mat.	Pouzdří Bush	Max.díra Max.Bore	Dp [mm]	De [mm]	Df [mm]	Dm [mm]	Di [mm]	F [mm]	S [mm]	R [mm]	m [kg]
60	20	14M-60-S20	9	GG	3020	75,0	267,38	264,58	-	159,0	224,0	33,0	51,0	9,0	12,59
37		14M-60-S37	7	GG	3020	75,0	267,38	264,58	-	159,0	224,0	51,0	51,0	0,0	14,23
68		14M-60-S68	6	GG	3525	100,0	267,38	264,58	-	-	224,0	84,0	65,0	9,5	24,28
90		14M-60-S90	6	GG	3525	100,0	267,38	264,58	-	-	224,0	106,0	66,0	20,0	26,53
125		14M-60-S125	6	GG	4030	115,0	267,38	264,58	-	-	224,0	141,0	76,0	32,5	30,92
64	20	14M-64-S20	9	GG	3020	75,0	285,21	282,41	-	159,0	242,0	33,0	51,0	9,0	13,84
37		14M-64-S37	7	GG	3020	75,0	285,21	282,41	-	159,0	242,0	51,0	51,0	0,0	15,58
68		14M-64-S68	6	GG	3525	100,0	285,21	282,41	-	-	242,0	84,0	65,0	9,5	27,86
90		14M-64-S90	6	GG	3525	100,0	285,21	282,41	-	-	242,0	106,0	66,0	20,0	30,30
125		14M-64-S125	6	GG	4030	115,0	285,21	282,41	-	-	242,0	141,0	76,0	32,5	35,34
72	20	14M-72-S20	9	GG	3020	75,0	320,86	318,06	-	159,0	278,0	33,0	51,0	9,0	15,51
37		14M-72-S37	7	GG	3020	75,0	320,86	318,06	-	159,0	278,0	51,0	51,0	0,0	17,24
68		14M-72-S68	7	GG	3525	100,0	320,86	318,06	-	178,0	278,0	84,0	65,0	9,5	25,74
90		14M-72-S90	7	GG	3525	100,0	320,86	318,06	-	178,0	278,0	106,0	66,0	20,0	26,36
125		14M-72-S125	7	GG	4030	115,0	320,86	318,06	-	215,0	278,0	141,0	76,0	32,5	37,71
80	20	14M-80-S20	9	GG	3020	75,0	356,51	353,71	-	159,0	314,0	33,0	51,0	9,0	18,13
37		14M-80-S37	7	GG	3020	75,0	356,51	353,71	-	159,0	314,0	51,0	51,0	0,0	20,32
68		14M-80-S68	7	GG	3525	100,0	356,51	353,71	-	178,0	314,0	84,0	65,0	9,5	29,86
90		14M-80-S90	7	GG	4030	115,0	356,51	353,71	-	215,0	314,0	106,0	76,0	15,0	35,61
125		14M-80-S125	7	GG	4030	115,0	356,51	353,71	-	215,0	314,0	141,0	76,0	32,5	42,02
90	20	14M-90-S20	10	GG	3020	75,0	401,07	398,27	-	159,0	360,0	33,0	51,0	9,0	19,47
37		14M-90-S37	8	GG	3020	75,0	401,07	398,27	-	159,0	360,0	51,0	51,0	0,0	29,85
68		14M-90-S68	8	GG	3525	100,0	401,07	398,27	-	178,0	360,0	84,0	65,0	9,5	31,24
90		14M-90-S90	7	GG	4030	115,0	401,07	398,27	-	215,0	360,0	106,0	76,0	15,0	41,90
125		14M-90-S125	7	GG	4030	115,0	401,07	398,27	-	215,0	360,0	141,0	76,0	32,5	51,29
112	20	14M-112-S20	10	GG	3020	75,0	499,11	496,31	-	159,0	456,0	33,0	51,0	9,0	24,25
37		14M-112-S37	8	GG	3020	75,0	499,11	496,31	-	159,0	456,0	51,0	51,0	0,0	27,43
68		14M-112-S68	8	GG	3525	100,0	499,11	496,31	-	178,0	456,0	84,0	65,0	9,5	39,25
90		14M-112-S90	8	GG	4535	125,0	499,11	496,31	-	215,0	456,0	106,0	90,0	8,0	70,89
125		14M-112-S125	8	GG	4535	125,0	499,11	496,31	-	215,0	581,0	141,0	89,0	26,0	65,64
140	20	14M-140-S20	10	GG	3020	75,0	623,89	621,09	-	159,0	581,0	33,0	51,0	9,0	20,96
37		14M-140-S37	10	GG	3525	100,0	623,89	621,09	-	206,0	581,0	51,0	65,0	7,0	33,55
68		14M-140-S68	8	GG	3525	100,0	623,89	621,09	-	206,0	581,0	84,0	65,0	9,5	40,87
90		14M-140-S90	8	GG	4535	125,0	623,89	621,09	-	215,0	581,0	106,0	90,0	8,0	74,56
125		14M-140-S125	8	GG	4535	125,0	623,89	621,09	-	215,0	581,0	141,0	89,0	26,0	67,90
168	37	14M-168-S37	10	GG	3525	100,0	748,66	745,87	-	206,0	706,0	51,0	65,0	7,0	64,50
68		14M-168-S68	8	GG	3525	100,0	748,66	745,87	-	206,0	706,0	84,0	65,0	9,5	73,30
90		14M-168-S90	8	GG	5040	130*	748,66	745,87	-	267,0	708,0	106,0	102,0	2,0	109,24
125		14M-168-S125	8	GG	5040	125,0	748,66	745,87	-	267,0	706,0	141,0	102,0	19,5	120,66
192	37	14M-192-S37	10	GG	4030	115,0	855,61	852,82	-	215,0	812,0	51,0	76,0	12,5	83,82
68		14M-192-S68	8	GG	4030	115,0	855,61	852,82	-	215,0	812,0	84,0	76,0	4,0	94,21
90		14M-192-S90	8	GG	5040	130,0	855,61	852,82	-	267,0	812,0	106,0	102,0	2,0	126,05
125		14M-192-S125	8	GG	5040	125,0	855,61	852,82	-	267,0	812,0	141,0	102,0	19,5	142,39

* Materiál: ST = ocel, GG = litina / ST = steel, GG = iron cast

TYMA CZ, s.r.o., Tel: +420 475 655 010, Fax: +420 475 655 018, e-mail: info@tyma.cz, www.tyma.cz, www.remeny-online.com